

California State University
NORTHRIDGE
Department of Police Services
University Police Division



LESSON PLAN

SUBJECT: Bus Transit Center Response

LENGTH: 20 minutes

PREPARED BY: Sgt. W. Smith

DATE PREPARED: April 12, 2012

APPROVED BY:

Gene P. Garcia, Chief

DATE APPROVED:

4/27/12

I. Performance Objectives/Job-Related Objectives:

The purpose of this training is to inform responding officers of possible police concerns regarding the transit system and familiarize them with the basic nomenclature of the busses that will be on campus in case of an incident that may need an on-board response. Officers will demonstrate a functional level of competency and understanding of the basic police concerns and officer safety issues when responding to a transit call for service.

II. Type of Instruction:

The instructor will review the basic nomenclature of a typical bus and the safety concerns related to an on-board response. Officers will board a bus and learn the basic layout including exits and door operation. The officers will be given assorted CVC and PC sections pertaining to the transit system for possible enforcement. Officers will conduct a "felony / high risk" bus take down as a practical exercise.

III. Course Outline:

A. Common calls for service on Transit Busses

1. Patron refusing to get off
2. Patron asleep / unable to wake
3. Patron disturbing the operator / others
4. Medical Emergency on board
5. Crime in progress

B. Enforcement Options

1. 640 (2) PC-disturbing others
2. 640 (5) PC – skateboarding, cycling, skating, motorized scooter, rollerblading
3. 640 (d)(2) PC –carrying flammable/ explosive liquid / acid on vehicle
4. 640(d)(3) PC- urinating on facility / vehicle
5. 41.27(c) LAMC- consuming in public
6. 415 PC – disturbing/ fighting in public
7. 21461 (a) CVC- Driving against posted signs
8. 21655.7 CVC- driving in designated lane for transit

IV. Practical Exercise

- A. Bus “take down” stop senerio / review
Officers will conduct a mock bus take down / clear the bus
- B. Evaluate senerio and review other possible outcomes

V. Closing

- A. Questions & Comments

Attention: Command Staff

From: Sgt. W. Smith

Subject: Possible concerns to be addresses regarding the new Transit Center on campus

It is my understanding that we are going to open a transit center here on campus and due to my past experience with the MTA PD I thought I may bring up several questions and possible concerns that may arise.

Questions:

1. How many lines / buses are expected at the location?
2. Where are these lines running and how often?
3. Is the transit center going to be used for dead-head / break stops?
4. Will the transit center have an active stop incorporated?

#167/741(DASH)
METROLINK

Possible Concerns:

1. Additional call load involving the following:
 - A. Transients sleeping on buses needing removal
 - B. Transients sleeping / congregating at the center
 - C. Lost / incoherent elderly that will require secured relocation
 - D. Lost / runaway juveniles that will require secured relocation
 - E. Busses in "emergency alarm" due to crimes in progress / accidental activations

Possible Concerns (cont)

- F. Skateboarders utilizing the location / 594pc / noise directly adjacent to University Hall
- G. Training for CSUN PD officers regarding officer safety on buses as well as “bus takedown procedures” and basic bus nomenclature / operation will need to be provided to all responding personnel.

Many of the possible concerns will obviously depend on the answers to some of the stated questions above. Not knowing what the overall / long term plans are for this Transit Center is what brought many of these concerns to light. If history repeats itself, the MTA will, in fact, eventually utilize this new facility. It's really a question of how they plan to utilize it and how busy the center will get.

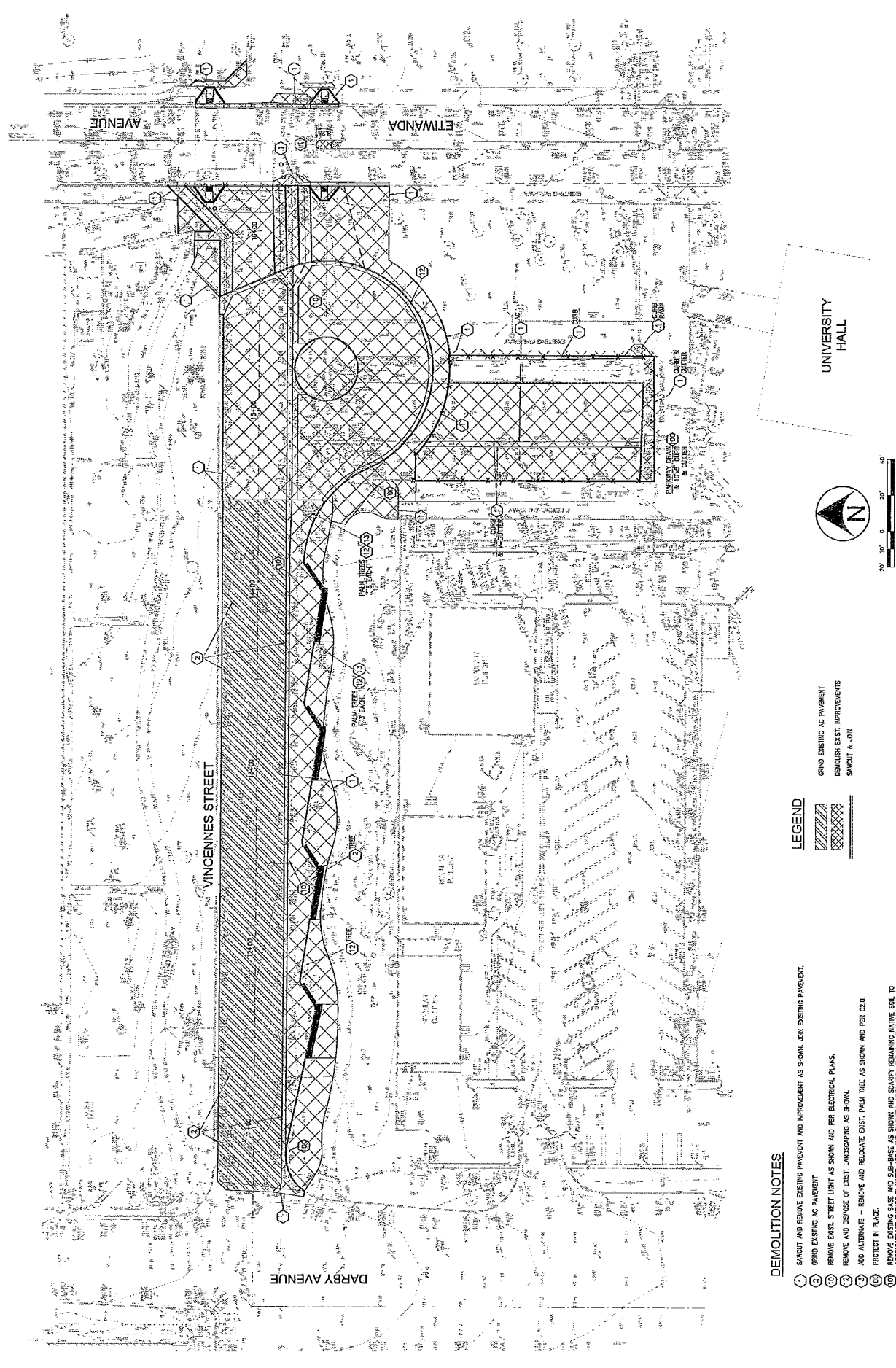

DEMOLITION NOTES

- 1 SAWCUT AND REMOVE EXISTING PAVEMENT AND IMPROVEMENTS AS SHOWN. JOIN EXISTING PAVEMENT.
- 2 GRIND EXISTING AC PAVEMENT
- 3 REMOVE EXIST. STREET LIGHT AS SHOWN AND PER ELECTRICAL PLANS.
- 4 REMOVE AND DISPOSE OF EXIST. LANDSCAPING AS SHOWN.
- 5 ADD ALTERNATE - REMOVE AND RELOCATE EXIST. PALM TREE AS SHOWN AND PER C2.0.
- 6 PROTECT IN PLACE.
- 7 NOT SHOWN ARE AREAS AND SPACES REMAINING IN PLACE SOLE TO ACCOMMODATE FUTURE PAVEMENT AS SHOWN. VERIFY WITH CLIENT WHITE SOIL OBSERVED ELSEWHERE ON PROJECT AND PER UNIVERSITY REPRESENTATIVE.

LEGEND

- GRIND EXISTING AC PAVEMENT
- CASUALTY EXIST. IMPROVEMENTS
- SAWCUT & JOIN

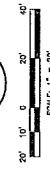

WHEELER & GRAY <small>CONSULTING ENGINEERS 600 SOUTH MAIN STREET, SUITE 200 ANN ARBOR, MI 48106-1500 TEL: 734.769.0700 FAX: 734.769.0705 WWW.WG-USA.COM</small>	CALIFORNIA STATE UNIVERSITY NORTHBRIDGE TRANSIT CENTER DEMOLITION PLAN	SHEET C1.3 <small>DATE: 02/07/2011 SCALE: 1" = 25' PROJECT: UIC JOB NO.: C1111.00</small>														
<table border="1" style="width: 100%; border-collapse: collapse;"> <tr> <th style="width: 10%;">NO.</th> <th style="width: 10%;">REV.</th> <th style="width: 10%;">DATE</th> <th style="width: 10%;">BY</th> <th style="width: 10%;">CHK.</th> <th style="width: 10%;">APP.</th> <th style="width: 10%;">DESCRIPTION</th> </tr> <tr> <td> </td> <td> </td> <td> </td> <td> </td> <td> </td> <td> </td> <td> </td> </tr> </table>	NO.	REV.	DATE	BY	CHK.	APP.	DESCRIPTION									
NO.	REV.	DATE	BY	CHK.	APP.	DESCRIPTION										